

## **OSTROVNÍ APARTMENT HOUSE**

**Location:** Prague city center, Ostrovní street, close to the National Theatre

**Building:** residence apartment house with recently renovated interior

**Vicinity:** tram stop, metro station, department store, grocery, restaurants, cafés, bakery

**Number of available apartments in the building: 2**

**Total capacity: 8**

### **Distance to important points:**

CERGE-EI Educational Center:	<b>0,75 miles</b>
Wenceslav Square	<b>0,43 miles</b>
Old Town Square	<b>0,6 miles</b>
Main Railway Station	<b>1,12 miles</b>
Prague Castle	<b>1,37 miles</b>
The closest metro station (line "B")	<b>0,125 miles</b>
The closest tram station (lines 6,9,18,21,22)	<b>0,125 miles</b>

## **OSTROVNÍ I APARTMENT**

<b>Capacity</b>	4 persons	<b>Bathroom</b>	1
<b>Floor</b>	1st	<b>Separated toilet</b>	yes
<b>Lift</b>	yes	<b>Shower</b>	yes
<b>Size</b>	100 m <sup>2</sup>	<b>Bath-tub</b>	yes
<b>Bedrooms</b>	2	<b>Washing machine</b>	yes
<b>Beds</b>	4	<b>Dryer</b>	no
<b>Living room</b>	yes	<b>Iron</b>	yes
<b>Satellite TV</b>	yes	<b>Ironing board</b>	yes
<b>Internet wifi</b>	on request	<b>Hair dryer</b>	yes
<b>Internet cable</b>	no	<b>Bed linen and towels</b>	yes
<b>Fully equipped kitchen</b>	yes	<b>Cleaning service</b>	yes
<b>Dishwasher</b>	no	<b>Balcony</b>	yes
<b>Dining area</b>	yes	<b>Airconditioned</b>	no

**Price (if occupied by 4 persons) 15.000 CZK/person/month**

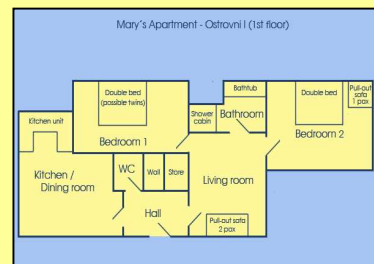

## OSTROVNÍ III APARTMENT

<b>Capacity</b>	4 persons	<b>Bathroom</b>	1
<b>Floor</b>	3rd	<b>Separated toilet</b>	yes
<b>Lift</b>	yes	<b>Shower</b>	yes
<b>Size</b>	100 m	<b>Bath-tub</b>	yes
<b>Bedrooms</b>	2	<b>Washing machine</b>	yes
<b>Beds</b>	4	<b>Dryer</b>	no
<b>Living room</b>	yes	<b>Iron</b>	yes
<b>Satellite TV</b>	yes	<b>Ironing board</b>	yes
<b>Internet wifi</b>	on request	<b>Hair dryer</b>	yes
<b>Internet cable</b>	no	<b>Bed linen and towels</b>	yes
<b>Fully equipped kitchen</b>	yes	<b>Cleaning service</b>	yes
<b>Dishwasher</b>	no	<b>Balcony</b>	yes
<b>Dining area</b>	yes	<b>Airconditioned</b>	no

**Price (if occupied by 4 persons): 15.000 CZK/person/month**

